

NOTES:

- 1. SUBSTRATE
UV GRADE FUSED SILICA
- 2. COATING (APPLY ACROSS CLEAR APERTURE)
HARD COATED
PERFORMANCE SPECS:
T(AVG) = 90% FROM 670 - 800nm @ 45 ° AOI
R(AVG) = 98% FROM 580 - 651nm @ 45 ° AOI
T(ABS) = 50% @ 660nm @ 45 ° AOI

3. FINE GRIND SURFACE

- 4. SURFACE QUALITY SPECIFICATIONS APPLY ACROSS CLEAR APERTURE
- 5. TRANSMITTED WAVEFRONT DISTORTION RMS @ 632.8nm ≤1λ
- 6. ROHS COMPLIANT

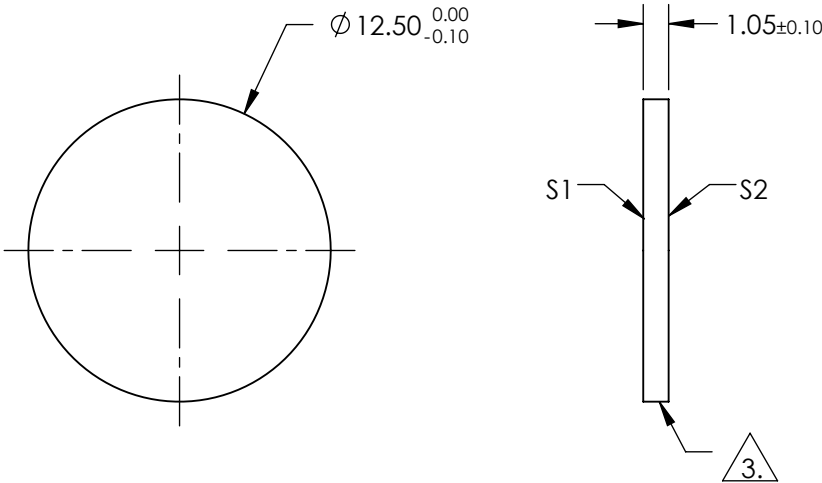
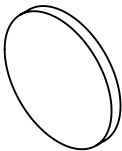

**FOR INFORMATION ONLY:
DO NOT MANUFACTURE
PARTS TO THIS DRAWING**

SPECIFICATIONS SUBJECT TO CHANGE WITHOUT NOTICE
DIMENSIONS ARE FOR REFERENCE ONLY

| | | | | | | | |
|-----------------|----------------------|----------------------|---------------------------|----|---------------|--|-----------------|
| | S1 | S2 | | | Edmund Optics | | |
| SHAPE | PLANO | PLANO | THIRD ANGLE PROJECTION | | TITLE | 660nm, 12.5mm DIAMETER, DICHOIC FILTER | |
| SURFACE QUALITY | 60-40 | 60-40 | | | | | |
| CLEAR APERTURE | Ø11.00 | Ø11.00 | | | | | |
| BEVEL | PROTECTIVE AS NEEDED | PROTECTIVE AS NEEDED | ALL DIMS IN | mm | DWG NO | 67060 | SHEET 1 OF 1 |