

NOTES:

1. SUBSTRATE MATERIAL:
N-SF5
2. COATING (APPLY ACROSS CLEAR APERTURE)

S1: ENHANCED ALUMINUM
R(avg) >95% @ 450 - 650nm

S2: NONE
3. POWER, IRREGULARITY, SURFACE QUALITY, AND COATING
SPECIFICATIONS APPLY ACROSS CLEAR APERTURE
4.

FINE GROUND SURFACE
5. ROHS COMPLIANT

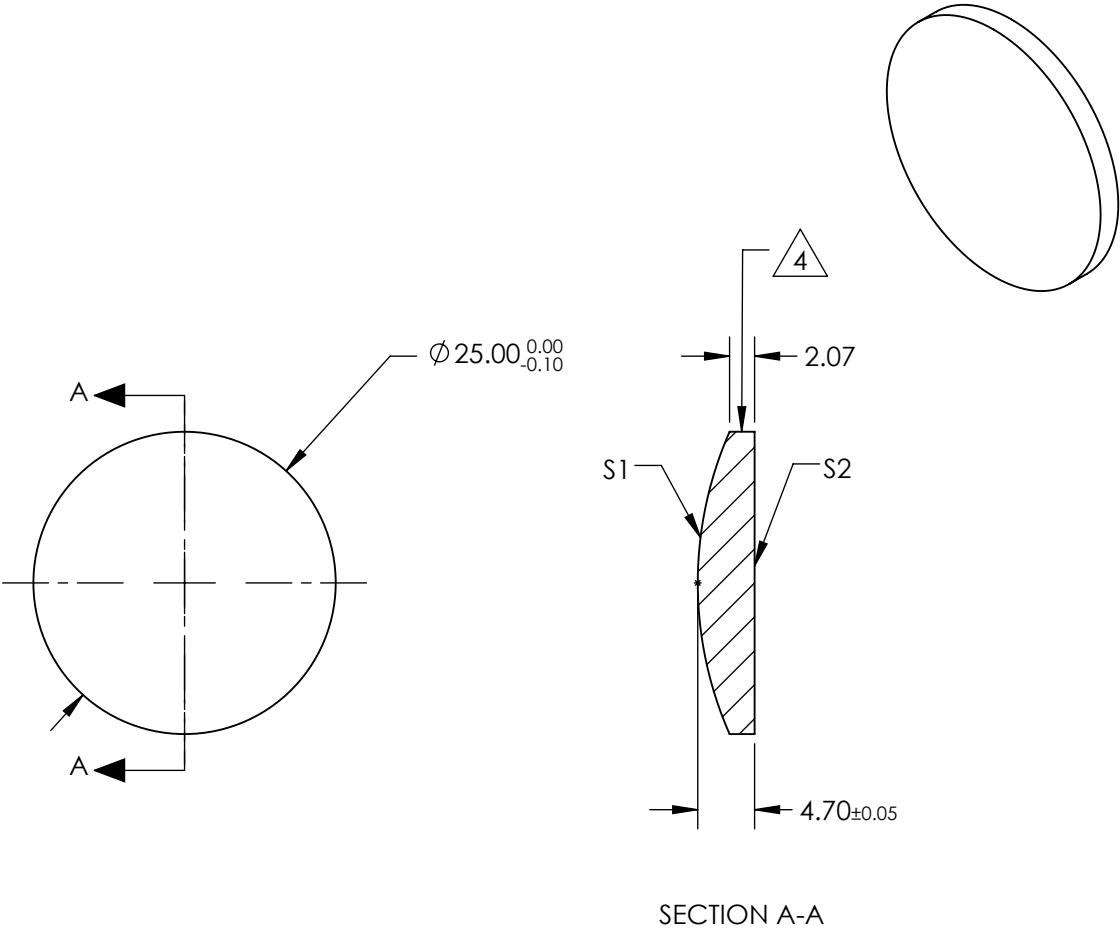

**FOR INFORMATION ONLY:
DO NOT MANUFACTURE
PARTS TO THIS DRAWING**

SPECIFICATIONS SUBJECT TO CHANGE WITHOUT NOTICE
DIMENSIONS ARE FOR REFERENCE ONLY

REV. A	S1	S2				
SHAPE	CONVEX	PLANO				
RADIUS	31	INFINITY				
EFFECTIVE FOCAL LENGTH	-15.5mm	N/A				
FOCAL LENGTH TOLERANCE	±2%	N/A				
SURFACE QUALITY	60-40	COMMERCIAL POLISH				
CLEAR APERTURE	90%	N/A				
BEVEL	PROTECTIVE AS NEEDED	PROTECTIVE AS NEEDED				
			THIRD ANGLE PROJECTION		TITLE	Ø25mm, -15.5mm FL ENHANCED ALUMINUM, CONVEX SPHERICAL MIRROR
			ALL DIMS IN	mm	DWG NO	64061
						SHEET 1 OF 1

Edmund Optics®