

NOTES:

- 1. SUBSTRATE: N-BK7
- 2. COATING (APPLY ACROSS CLEAR APERTURE)

S1: ALUMINUM WITH PROTECTIVE OVERCOAT  
R(AVG) > 85% FROM 400-700nm @ 0° AOI  
R(AVG) > 90% FROM 400-2,000nm @ 0° AOI

S2: NONE

3. FINE GRIND SURFACE

- 4. POWER, IRREGULARITY, AND SURFACE QUALITY SPECIFICATIONS  
APPLY ACROSS CLEAR APERTURE
- 5. ROHS COMPLIANT

FOR INFORMATION ONLY:  
DO NOT MANUFACTURE  
PARTS TO THIS DRAWING

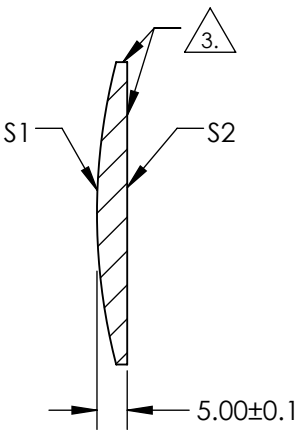
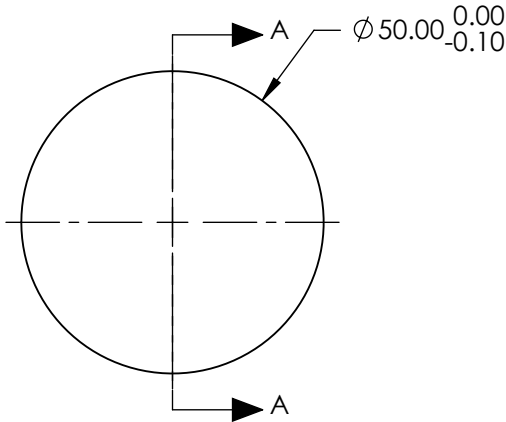
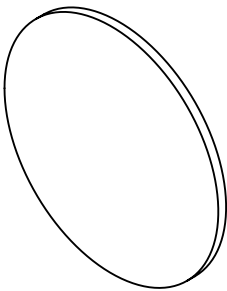

SECTION A-A

SPECIFICATIONS SUBJECT TO CHANGE WITHOUT NOTICE  
DIMENSIONS ARE FOR REFERENCE ONLY

	S1	S2
SHAPE	CONVEX	PLANO
RADIUS	100mm	N/A
SURFACE QUALITY	60-40	N/A
FOCAL LENGTH TOLERANCE	±2%	N/A
BEVEL	PROTECTIVE AS NEEDED	PROTECTIVE AS NEEDED

THIRD ANGLE  
PROJECTION

ALL DIMS IN mm

 **Edmund Optics®**

TITLE	Ø50mm, -50mm FL PROTECTED ALUMINUM, CONVEX MIRROR	
DWG NO	87662	SHEET 1 OF 1