

[See all 10 Products in Family](#)

**TECHSPEC® 12mm LT Series Fixed Focal Length Lens**



12mm FL Front, #14-361



Stock **#14-361** CLEARANCE **2 In Stock**

⊖ 1 ⊕ **A\$2,297<sup>.52</sup>**

**ADD TO CART**

Volume Pricing	
Qty 1+	<b>A\$2,297.52</b> each
Need More?	<a href="#">Request Quote</a>

**Note:** This item requires accessories for use | [Learn More](#)

Product Downloads

**General**

LT Series **Product Family:**

Diameter includes liquid lens **Note:**

Fixed Focal Length Lens **Type:**

**Integrated Liquid Lens Model:**  
Optutune EL-16-40-TC

**Imaging Lens Type:**  
Integrated Liquid Lens to Adjust Focus  
Electronically

**Special Type of Lens:**  
Liquid Lens Focusable

## Physical & Mechanical Properties

**Iris Option:**  
Fixed

**Length (mm):**  
74.30

**Maximum Diameter (mm):**  
82

**Outer Diameter (mm):**  
82

**Weight (g):**  
245.5

**Maximum Rear Protrusion (mm):**  
0

## Optical Properties

**Horizontal Field of View @ Max Sensor Format:**  
432.6mm - 60.0°

**Field of View at Max Sensor Format:**  
Horizontal: 434.3mm - 59.2°  
Vertical: 321mm - 45.7°  
Diagonal: 552.2mm - 71.5°

**Horizontal Field of View, 1.1" Sensor:**  
432.6mm - 60.0°

**Horizontal Field of View, 1" Sensor:**  
387.6mm - 54.7°

**Horizontal Field of View, 2/3" Sensor:**  
262.3mm - 38.8°

**Horizontal Field of View, 1/1.8" Sensor:**  
213.6mm - 32.0°

**Horizontal Field of View, 1/2" Sensor:**  
189.4mm - 28.5°

**Horizontal Field of View, 1/2.5" Sensor:**  
171.4mm - 25.9°

**Horizontal Field of View, 1/3" Sensor:**  
141.5mm - 21.5°

**Horizontal Field of View, 1/4" Sensor:**  
105.9mm - 16.2°

**Maximum Image Circle (mm):**  
17.60

**Numerical Aperture NA, Object Side:**  
0.006

**Number of Elements (Groups):**  
10 (9)

**Focal Length FL (mm):**  
12.00

**Working Distance (mm):**  
350 - ∞

**Aperture (f/#):**  
f/2.8

**Coating:**  
λ/4 MgF<sub>2</sub>

**Coating Specification:**  
λ/4 MgF<sub>2</sub>

**Entrance Pupil Position (mm):**  
31.2

**Object Space Principal Plane (mm):**  
39.92

**Image Space Principal Plane (mm):**  
2.45

**Maximum Distortion (%):**  
-4.23

**Exit Pupil Position (mm):**  
-26.58

**Lens Wavelength Range:**  
VIS

## Sensor

1.1"	Maximum Sensor Format:
2.74	Pixel Size (µm):

## Threading & Mounting

M62 x 0.75 (Male)	Filter Thread:
<a href="#">#34-236 (Required)</a>	Filter Thread Adapter:
M48 x 0.5 (Male)	Front Thread:
C-Mount	Mount:

## Environmental & Durability Factors

-20 to +60	Storage Temperature (°C):
------------	---------------------------

## Regulatory Compliance

<a href="#">View</a>	Certificate of Conformance:
----------------------	-----------------------------

## Product Details

- 1.1" Sensor, C-Mount Lens, up to 12 MegaPixels, 3.45µm Pixel Size Sensor
- Integrated Liquid Lens Allows for Dynamic Autofocus
- Liquid Tunable (LT) Lens Maximizes the Liquid Lens Capabilities for Resolution, Range and Focus Speed
- 12 to 25mm Focal Length

TECHSPEC® LT Series Fixed Focal Length Lenses feature a high-resolution f/2.8 optical design with an integrated Optotune liquid lens for fast electronic focus. The increased light throughput f/2.8 aperture is ideal for high-speed machine vision applications. When combined with an appropriate camera and software, the focus tunable liquid lens provides the active focus control needed to achieve an autofocus solution. These C-Mount lenses are optimized for 1.1" sensors and have front filter threading to integrate imaging filters to meet application requirements. TECHSPEC® LT Series Fixed Focal Length Lenses are ideal for machine vision and factory automation applications where focusing at multiple distances is required, such as quality inspection systems, rapid automation, and package sorting. The TECHSPEC® LT Series Fixed Focal Length Lenses won the [Gold-Level 2021 Vision Systems Design Innovators Award](#) and [third place 2021 reader's choice inspect Award](#).

# inspect

## award 2021

---

# winner

Note: Hirose cables (2 length options) and Lens Driver are required for operation and sold separately.

### Technical Information

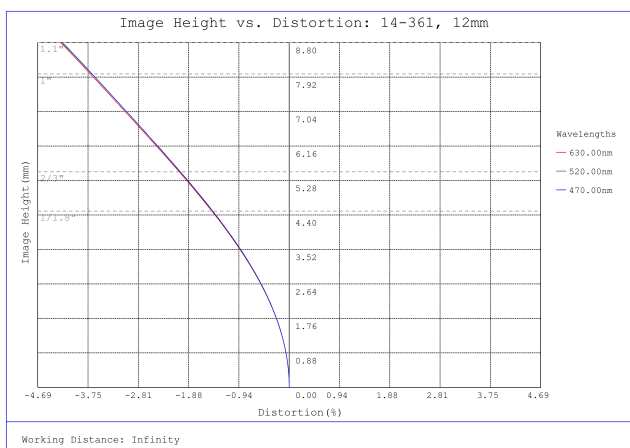

#14-361, 12mm LT Series Fixed Focal Length Lens, Distortion Plot

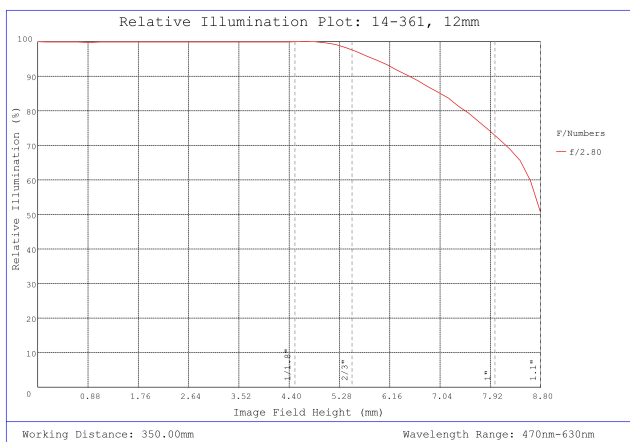

#14-361, 12mm LT Series Fixed Focal Length Lens, Relative Illumination Plot

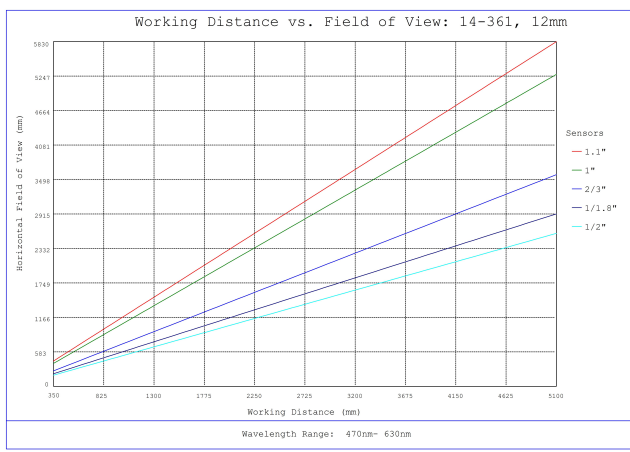

#14-361, 12mm LT Series Fixed Focal Length Lens, Working Distance versus Field of View Plot

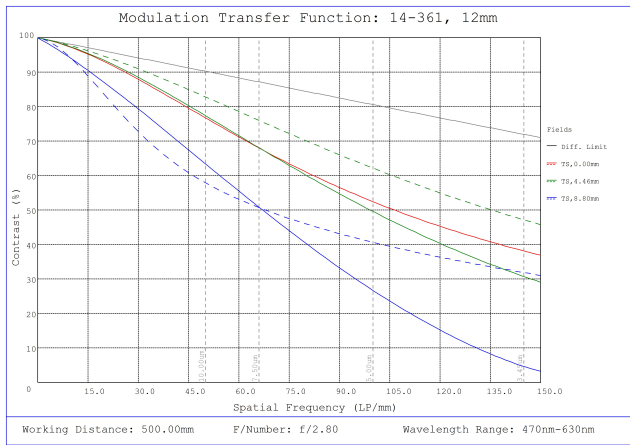

#14-361, 12mm LT Series Fixed Focal Length Lens, Modulated Transfer Function (MTF) Plot, 500mm Working Distance, f2.8

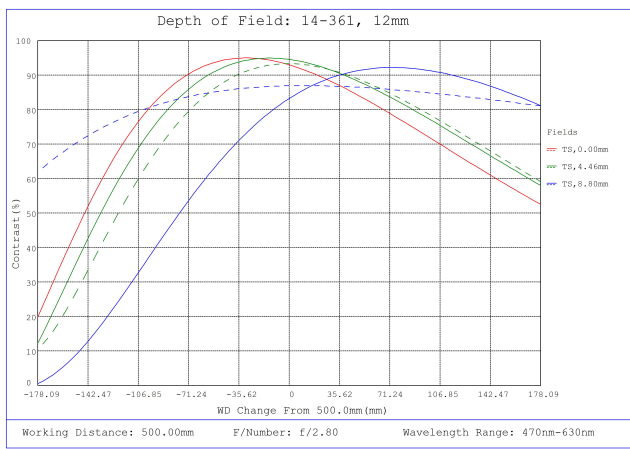

#14-361, 12mm LT Series Fixed Focal Length Lens, Depth of Field Plot, 500mm Working Distance, f2.8

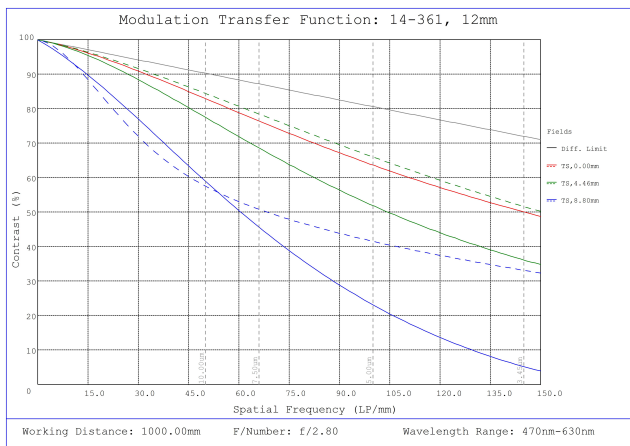

#14-361, 12mm LT Series Fixed Focal Length Lens, Modulated Transfer Function (MTF) Plot, 1000mm Working Distance, f2.8

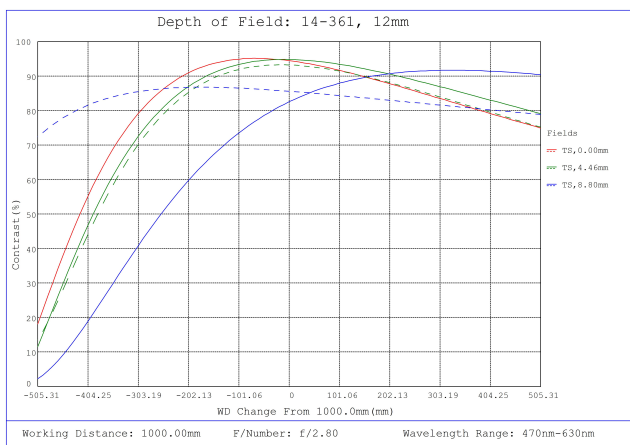

#14-361, 12mm LT Series Fixed Focal Length Lens, Depth of Field Plot, 1000mm Working Distance, f2.8

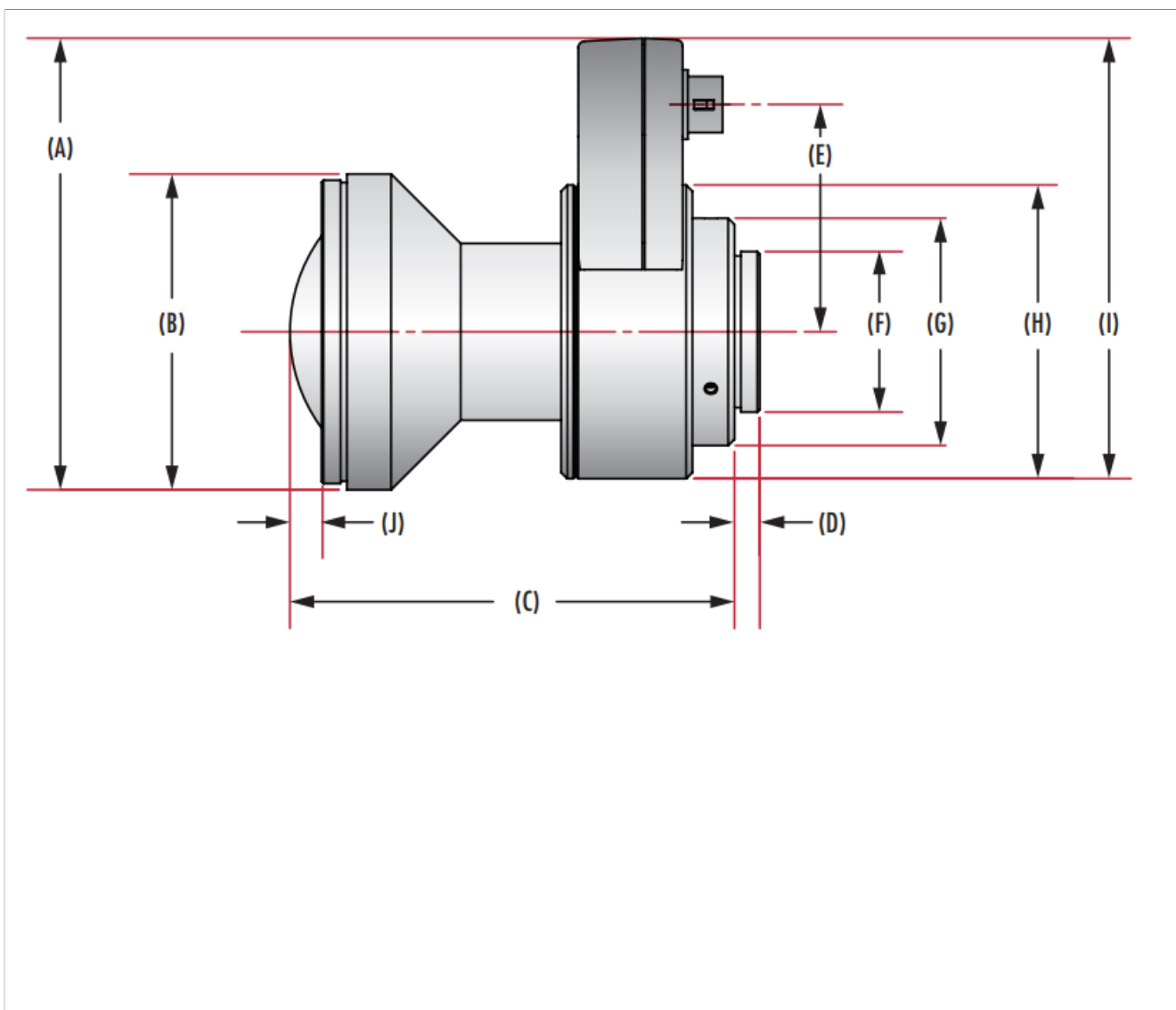

Focal Length	Stock No.	(A)	(B)	(C)	(D)	(E)	(F)	(G)	(H)	(I)	(J)
12mm	<a href="#">#14-361</a>	71.5	50.0	70.3	4.0	36.0	C-Mount	36.0	46.5	69.75	5.01
16mm	<a href="#">#14-362</a>	75.0	57.0	85.1	4.0	36.0	C-Mount	34.5	47.0	70.0	-
25mm	<a href="#">#14-363</a>	78.5	64.0	95.5	4.0	36.0	C-Mount	40.0	47.0	70.0	-

### Compatible Cameras